

# PRELIMINARY PLAT OF Mustang Creek Subdivision

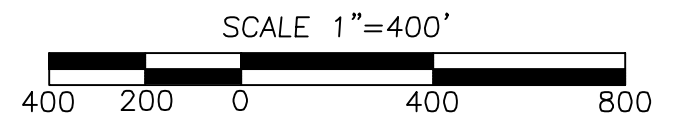
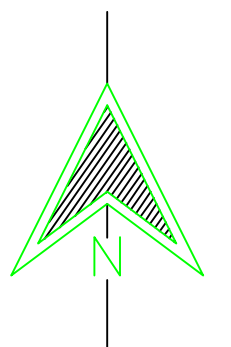

### Basis of Bearings

Being derived from GPS observations in the Texas State Plane Coordinate System, NAD 1983 Texas Central Zone, made on April 22, 2015.

Surveyor's Note: No Survey was made to reestablish Patent Survey Lines and/or Corners. Those shown hereon are approximate, unless otherwise noted.

Surveyor's Note: All visible and/or apparent easements and encroachments that were locatable on the ground have been shown on this plat. Always use the Texas One Call System or www.texas811.org, before performing any excavations.

Sur. 1951  
A-1204

Sur. 112  
A-1372

Sur. 1950  
A-1203

Sur. 111  
A-314

Sur. 102  
A-1108

Sur. 78  
A-1400

Sur. 1970  
A-1857

Sur. 1894  
A-740

Delio Oregon, et ux  
294.05 acres  
Vol. 31, Pg. 301  
Deed of Trust Records of  
Concho County, Texas

Den-Moore-Ranch LP  
2469.8 acres  
Vol. 226, Pg. 234  
Official Public Records of  
Concho County, Texas

Mehaffey Mesquite Enterprises, Ltd.  
2297.375 acres  
Book 254, Pg. 885  
Official Public Records of  
Concho County, Texas

Troy Allen Choate  
North 588 acres of 1142.67 acres  
Vol. 121, Pg. 683  
Deed Records of  
Concho County, Texas

Steven D. Crews and Luther W. Lott, Jr.  
326.138 acres  
Vol. 221, Pg. 638  
Official Public Records of  
Concho County, Texas

F.M. 2134  
100 ft. right-of-way  
average paved  
width is 24.60 ft.

F.M. 2134  
100 ft. right-of-way  
average paved  
width is 24.60 ft.

F.M. 2134  
100 ft. right-of-way  
average paved  
width is 24.60 ft.

County Road 4249  
average finished  
colicé & gravel  
width is 24.22 ft.

County Road 4249  
average finished  
colicé & gravel  
width is 24.22 ft.

County Road 4249  
average finished  
colicé & gravel  
width is 24.22 ft.

LEGEND	
●	1/2" Iron Stake set with cap marked "6163"
○	Iron Stake found, as noted
○	Found concrete right-of-way marker
○	Fence post found, as noted
—	Fence Line
—	Overhead Power Line
—	Patent survey lines
—	Pipeline

STATE OF TEXAS  
COUNTY OF McMULLEN  
I hereby certify that this plat is an accurate representation of a survey as made on the ground, under my supervision and direction, and that there are no visible or apparent encroachments or encroachments, except as shown hereon.  
Dated this \_\_\_\_\_ day of \_\_\_\_\_, 2015.

PRELIMINARY - THIS DOCUMENT SHALL NOT BE FILED FOR ANY PURPOSE

Stacy L. Little  
S.P.L.S. No. 6163  
South Texas Geomatics  
Land Surveying & Mapping  
P.O. Box 144  
Callahan, Texas 76007  
(361) 449-0327

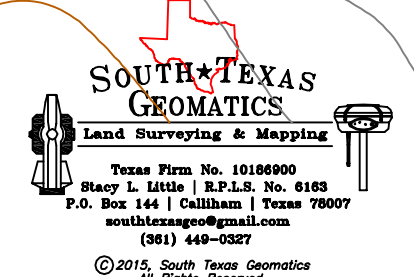

SHEET	1 OF 1
SCALE	1"=400'
DATE	7-7-15
DWG. #	???